

I. Rinne / Channel:

pro NW200 mini 100/120 V-E

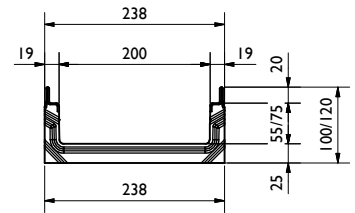

pro NW200 mini 100/120 G

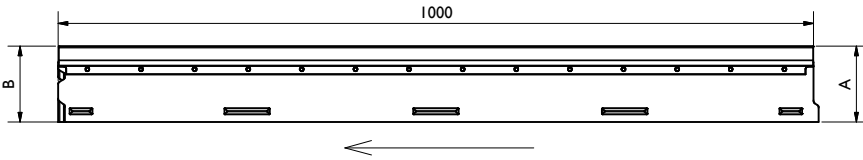
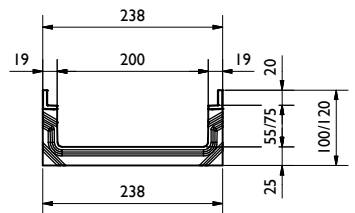
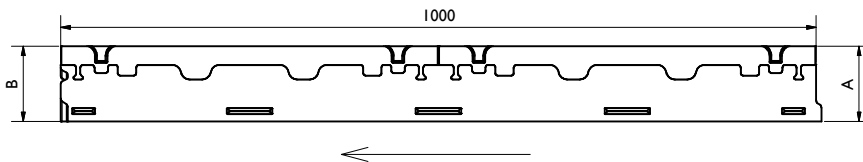

pro NW200 mini 200 V-E

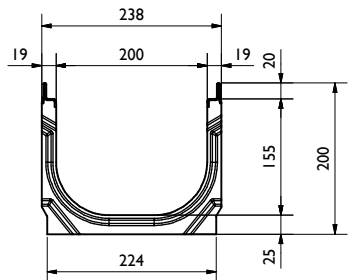
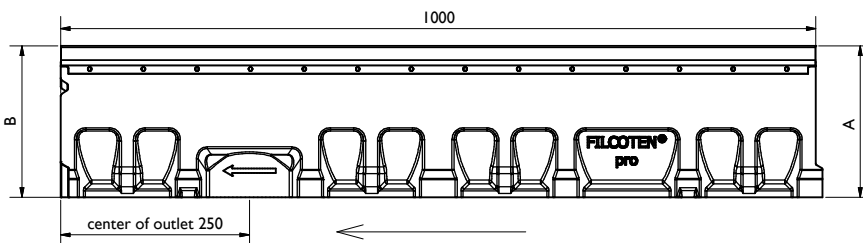

pro NW200 mini 200 G

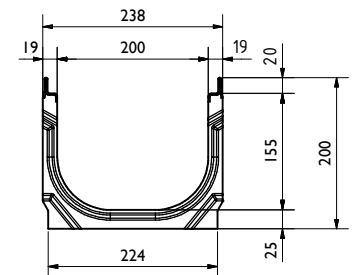
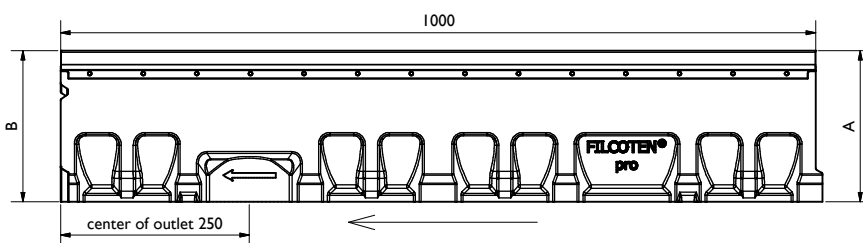

Rinne / channel - Maße / dimensions [mm]						
Typ	Höhe A height A	Höhe B height B	Länge length	BG code V	BG code E	BG code G
mini 100	100	100	1000	10520202	10520302	10520102
mini 120	120	120	1000	10520200	10520300	10520100
mini 200	200	200	1000	10520201	10520301	10520101

Legende / explanation:	
V:	verzinkter Stahl / galvanized steel
E:	Edelstahl / stainless steel
G:	Guß Eisen / ductil iron
H:	Holz / wood

data sheet:

FILCOTEN pro NW200

I. Rinne / Channel:

pro NW200 V-E

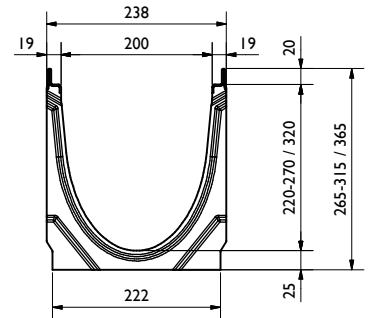
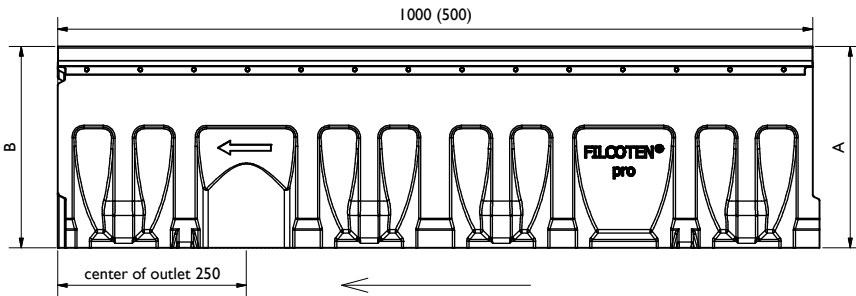

pro NW200 G

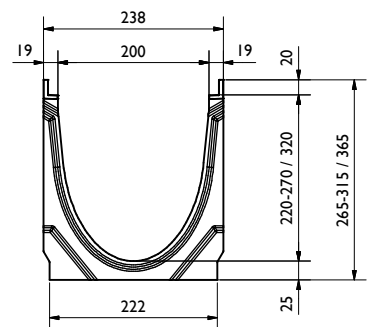
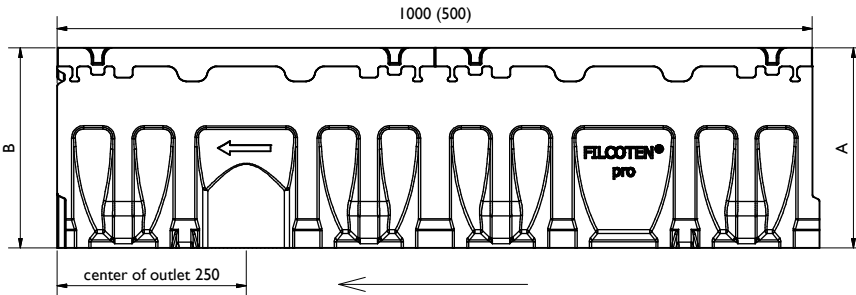

pro NW200 V, Nr. 5-0 f. seitl. Bohrung/f. side outlet drilling

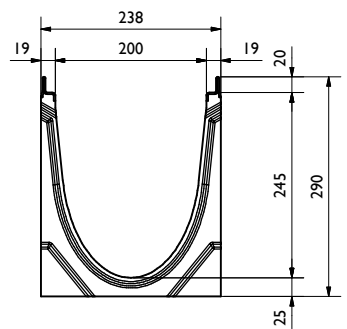
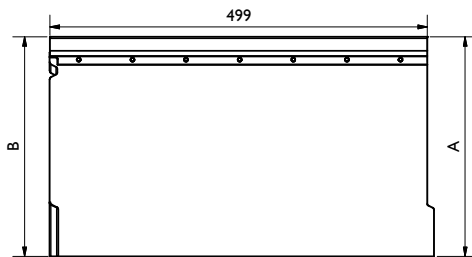

pro NW200 G, Nr. 5-0 f. seitl. Bohrung/f. side outlet drilling

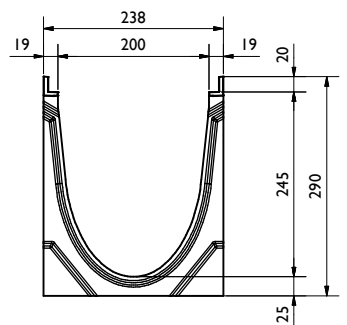
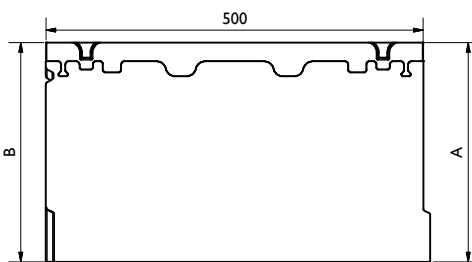

Rinne / channel - Maße / dimensions [mm]						
Typ	Höhe A height A	Höhe B height B	Länge length	BG code V	BG code E	BG code G
0 (0,5m)	265	265	500	10620280	10620380	10620180
1	265	270	1000	10620201	10620301	10620101
2	270	275	1000	10620202	10620302	10620102
3	275	280	1000	10620203	10620303	10620103
4	280	285	1000	10620204	10620304	10620104
5	285	290	1000	10620205	10620305	10620105
5-0	290	290	1000	10620261	10620361	10620161
5-0 (0,5m)	290	290	500	10620281	10620381	10620181
6	290	295	1000	10620206	10620306	10620106
7	295	300	1000	10620207	10620307	10620107
8	300	305	1000	10620208	10620308	10620108
9	305	310	1000	10620209	10620309	10620109
10	310	315	1000	10620210	10620310	10620110
10-0	315	315	1000	10620262	10620362	10620162
20-0	365	365	1000	10620264	10620364	10620164

Legende / explanation:	
V:	verzinkter Stahl / galvanized steel
E:	Edelstahl / stainless steel
G:	Gußbeisen / ductil iron
H:	Holz / wood

2. Gitterrost / Mesh grating:

B125kN MW30/10: V I7020220 (I7020221)

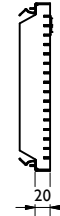
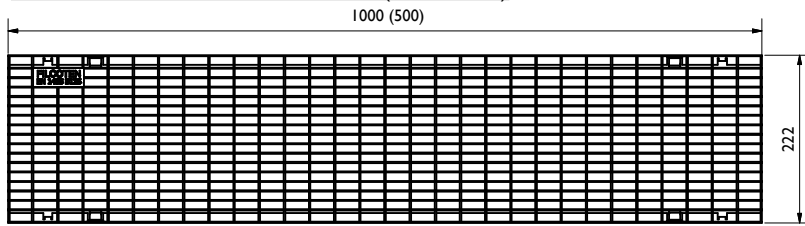

C250kN MW30/10: V I7020222 (I7020223), E I7020322 (I7020323)

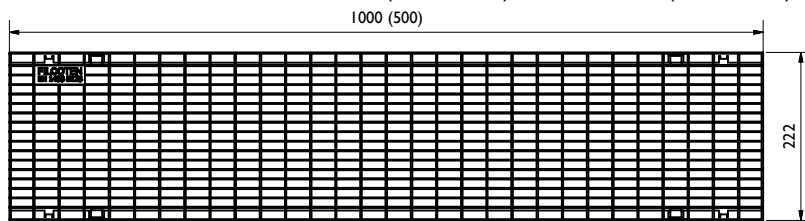

A (1 : 2)



D400kN MW25/10: V I7020226 (I7020227), E I7020326 (I7020327)

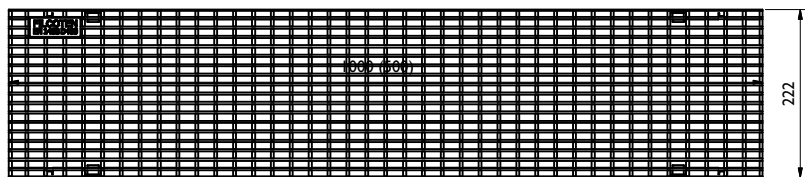

2. Lochrost / Perforated grating:

C250kN d6: V I7020228 (I7020229), E I7020328 (I7020329)

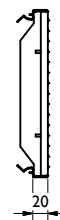
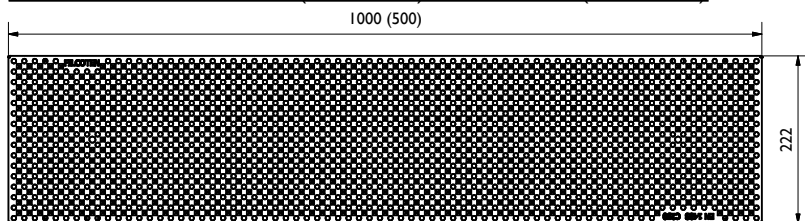

2. Gußrost / Ductil iron grating:

C250kN MW29/13: GJS 17020101

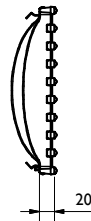
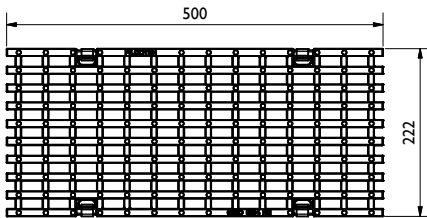

D400kN MW29/13: GJS 17020104

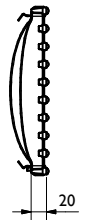
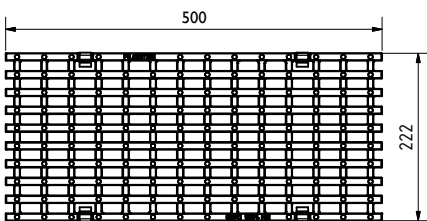

E600kN SW14/200: GJS 17020105

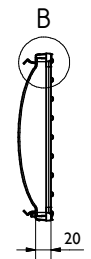
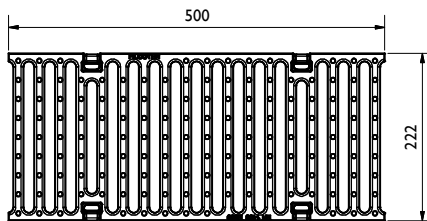

B (1 : 2)



E600kN MW22/13: GJS 17020103, 4-fach verschraubbar/4-times bolted

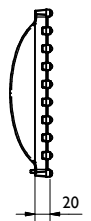
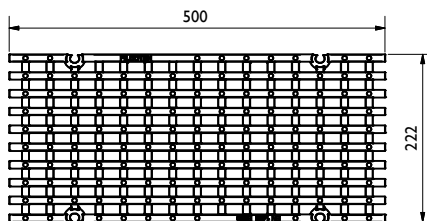

F900kN SW2x14/95: GJS 17020107, 4-fach verschraubbar/4-times bolted

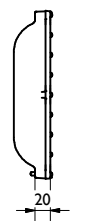
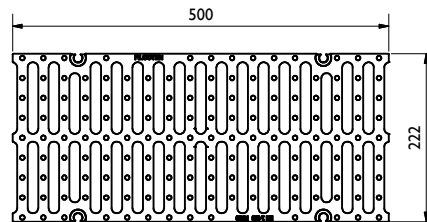

data sheet:

FILCOTEN pro NW200

3. Sinkkasten / Sump unit:

(optional: Schlammeimer / Silt bucket: 22512)

4. Stirn-/ Endplatte / End cap:

V 10620290, E 10620390

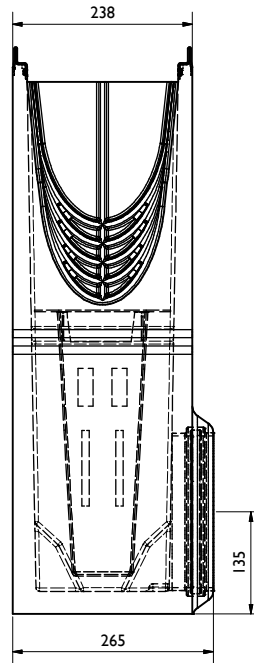
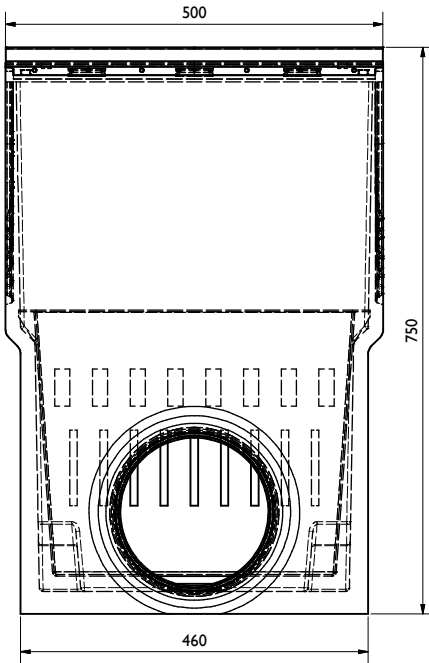

V 19020230, E 19020330

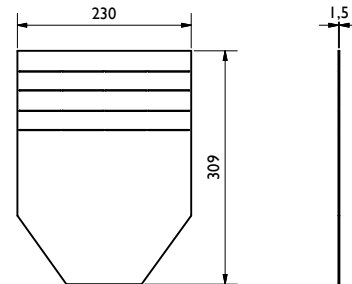

V 19020231, E 19020331

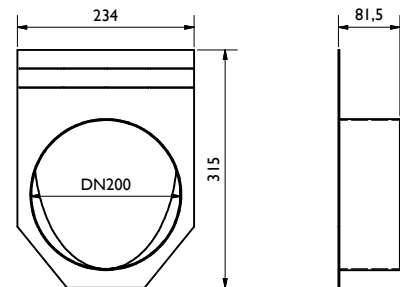

G 10620190

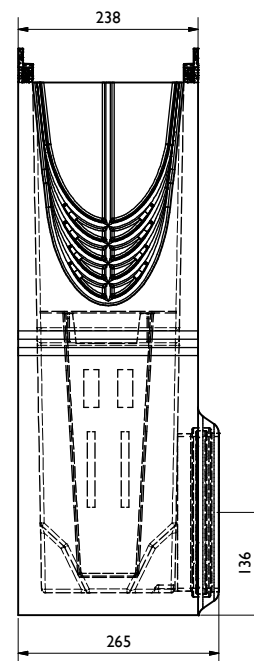
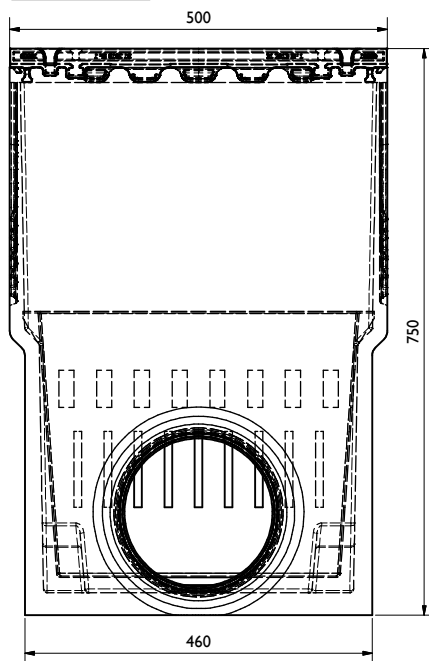

mini: V 19015200, E 19015300

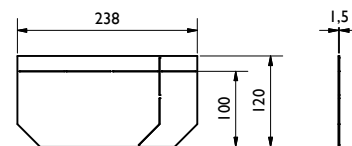

5. Vandalismus Verriegelung / Anti-vandalism locking device:

32089:

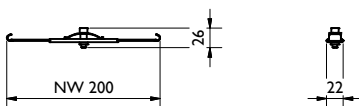

6. Verschraubungsmaterial / Bolting material:

V 32103

E 32109:

